



Parcel: 22-2517301.002
AMY L. BERNING
Shelby County Auditor | Shelby County, Ohio

Year: 2024



SUMMARY

Deeded Name	DEBORA J JONES	Taxpayer	JONES DEBORA J
Owner	JONES DEBORA J 2400 STATE ROUTE 48 HOUSTON OH 45333-9644		2400 STATE ROUTE 48 HOUSTON OH 45333-9644
Tax District	22-LORAMIE TWP HHSD HAD HFD	Land Use	510-SINGLE FAMILY DWELLING
School District	HARDIN-HOUSTON LSD	Subdivision	
Neighborhood	00765-LORAMIE TWP-HHSD	Legal	R05 T09 S17 PT W 1/2 SW QR 180-25-17-301-002 PLAT V22 P312
Location	2400 STATE ROUTE 48 HOUSTON OH 45333	Routing Number	
CD Year		Map Number	
Acres	5.0010	Sold	
		11/02/2017	Sales Amount 0.00

VALUE

District	22-LORAMIE TWP HHSD HAD HFD
Land Use	510-SINGLE FAMILY DWELLING

	Appraised	Assessed
Land	56,770	19,870
Improvement	201,890	70,660
Total	258,660	90,530
CAUV N	0	0
Homestead N	0	0
OOC Y	221,840	77,640
Taxable	258,660	90,530

CURRENT CHARGES

Full Rate	60.070000		
Effective Rate	40.299025		
Qualifying Rate	34.247682		
	Prior	First	Second
Tax	0.00	1,635.91	1,635.91
Special	0.00	10.61	10.60
Total	0.00	1,646.52	1,646.51
Paid	0.00	1,646.52	0.00
Due	0.00	0.00	1,646.51

FUTURE CHARGES

Type	Description	Amount
Special Assessments	070 KLASSE JOINT OPEN/MIAMI (RR-36)	14.34
Special Assessments	447 LORAMIE CREEK (RR-64)	5.87
Special Assessments	464 MIAMI CONSERVANCY DIST	1.00

TRANSFER HISTORY

Date	Conveyance	Deed Type	Sales Amount	Valid	# of Properties
11/02/2017	Buyer: JONES DEBORA J Seller: JONES DEBORA J	693	QUIT CLAIM	\$0.00	N 1
04/11/2002	Buyer: JONES DEBORA J Seller: MARSHAL DEBORA	264	QUIT CLAIM	\$0.00	N 1
03/25/1998	Buyer: MARSHAL DEBORA Seller: MARSHAL ALLAN	170	QUIT CLAIM	\$0.00	N 1
01/07/1991	Buyer: MARSHAL ALLAN Seller: * NOT ON FILE *	9	???	\$15,000.00	Y 1

LAND

Type	Dimensions	Description	Value
HS-HOME SITE	1.0000	Acres	32,000
RD-ROAD	0.1900	Acres	0
SA-SMALL ACREAGE	3.8100	Acres	24,770
		Total	56,770

DWELLING

Card 1					
Style	1-CONVENTIONAL	Family Rooms	0	Heating	Y
Stories	1.00	Dining Rooms	0	Cooling	Y
Rec Room Area	0	Year Built	1991	Grade	C
Finished Basement	0	Year Remodeled		Fireplace Openings	0
Rooms	10	Full Baths	2	Fireplace Stacks	0
Bed Rooms	4	Half Baths	0	Living Area	1,904
		Other Fixtures	0	Total Area	3,808
				Value	189,840

OTHER IMPROVEMENT

Card	Type	Year Built	Year Remodeled	Condition	Dimensions	Description	Size	Value
1	33-POLE BUILDING	2001		A-AVERAGE	30 X 40	Length x Width (Optional)	1,200	12,050
							Total	12,050

SKETCH

Card 1

ID	Description	Size	Floor	Floor Area (ft²)	Living Area (ft²)
A	1SB/B (1 STORY BRICK / BASEMENT)	1,064	First Floor	1,904	1,904
B	OFP (OPEN FRAME PORCH)	224	Basement	1,904	0
C	1SB/B (1 STORY BRICK / BASEMENT)	840	Total	3,808	1,904
D	WDD (WOOD DECK)	144			
E	2CBAS (2 CAR BASEMENT GARAGE)	0			
2	33-POLE BUILDING	1,200			

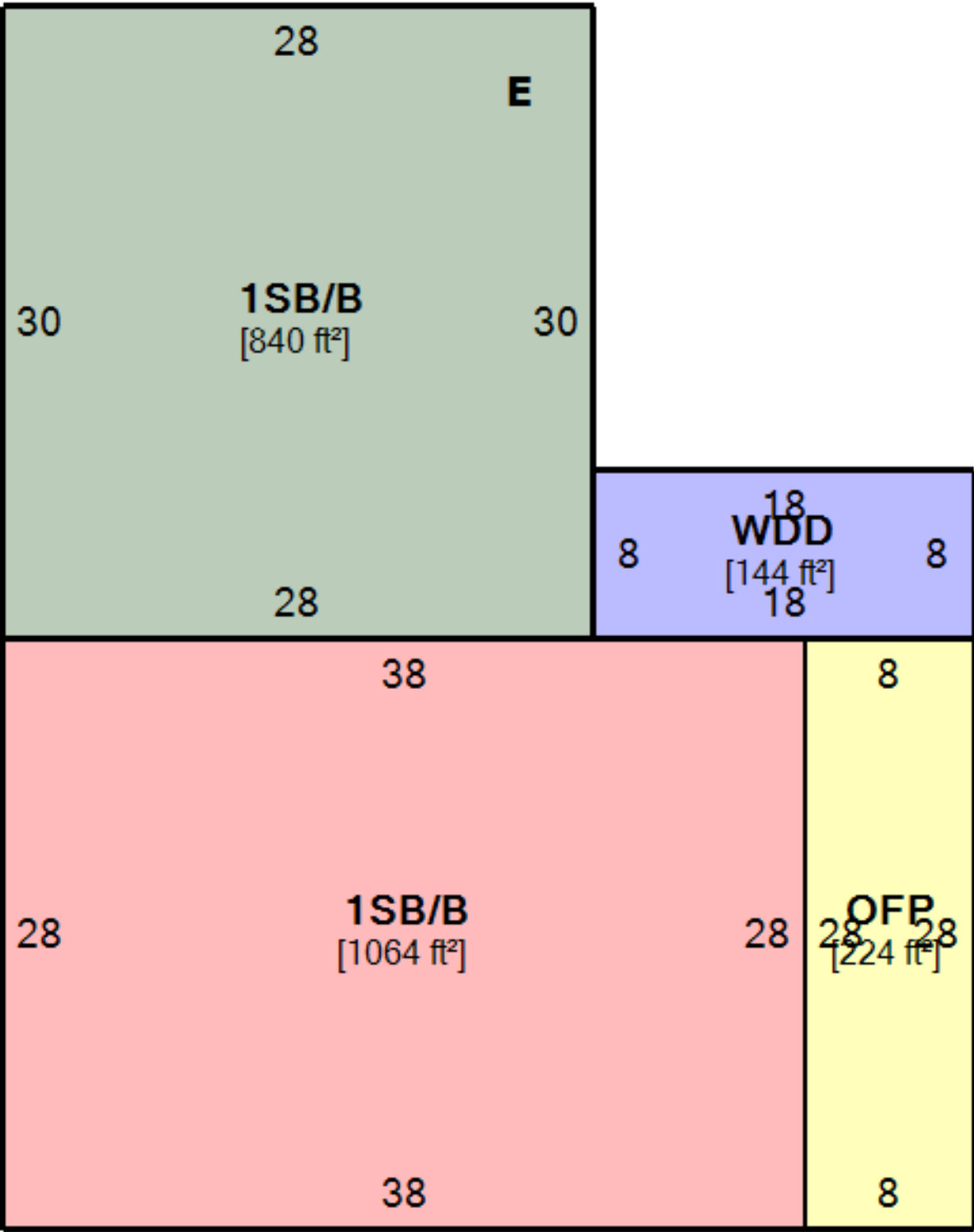

2