



Parcel: 36-2332476.004

Year: 2024

AMY L. BERNING

Shelby County Auditor | Shelby County, Ohio



SUMMARY

Table with property details: Deeded Name (DANIEL A CASE), Owner (CASE DANIEL A), Taxpayer (CASE DANIEL A), Tax District (36-ORANGE TWP SIDNEY SD SAD), Land Use (510-SINGLE FAMILY DWELLING), School District (SIDNEY CSD), Subdivision, Neighborhood (00994-ORANGE TOWNSHIP), Location (16875 DEAM RD), CD Year (2024), Map Number, Acres (1.5000), Sold, Routing Number, Sales Amount (0.00)

VALUE

Table with value breakdown: District (36-ORANGE TWP SIDNEY SD SAD), Land Use (510-SINGLE FAMILY DWELLING), Appraised (Land: 34,670, Improvement: 65,200, Total: 99,870), Assessed (Land: 12,130, Improvement: 22,820, Total: 34,950), CAUV (N), Homestead (N), OOC (Y), Taxable (99,870)

CURRENT CHARGES

Table with current charges: Full Rate (61.80000), Effective Rate (38.980166), Qualifying Rate (36.429675), and a detailed breakdown by period (Prior, First, Second) for Tax, Special, Penalty, Total, Paid, and Due.

FUTURE CHARGES

Table with future charges: Type (Special Assessments), Description (080 ELSNER BRUSH CREEK DITCH (RR-16), 464 MIAMI CONSERVANCY DIST), Amount (6.30, 1.00)

TRANSFER HISTORY

Table with transfer history: Date, Conveyance, Deed Type, Sales Amount, Valid, # of Properties. Includes transactions from 06/15/1992 to 07/11/2022.

LAND

Table with land details: Type (HS-HOME SITE, RD-ROAD, SA-SMALL ACREAGE), Dimensions, Description, Value (32,000, 0, 2,670), Total (34,670)

DWELLING

Card 1							
Style	1-CONVENTIONAL	Family Rooms	0	Heating			Y
Stories	2.00	Dining Rooms	0	Cooling			N
Rec Room Area	0	Year Built	1900	Grade			D+
Finished Basement	0	Year Remodeled		Fireplace Openings			0
Rooms	6	Full Baths	1	Fireplace Stacks			0
Bed Rooms	4	Half Baths	0	Living Area			1,920
		Other Fixtures	0	Total Area			2,400
				Value			64,820

OTHER IMPROVEMENT

Card	Type	Year Built	Year Remodeled	Condition	Dimensions	Description	Size	Value
1	04-SHED	1900		F-FAIR	10 X 16	Length x Width (Optional)	160	380
						Total		380

SKETCH

Card 1

ID	Description	Size	Floor	Floor Area (ft ²)	Living Area (ft ²)
A	2SF/.5B (2 STORY FRAME / .5 BASEMENT)	960	First Floor	960	960
B	OFP (OPEN FRAME PORCH)	128	Full Upper Floor	960	960
2	04-SHED	160	Basement	480	0
			Total	2,400	1,920

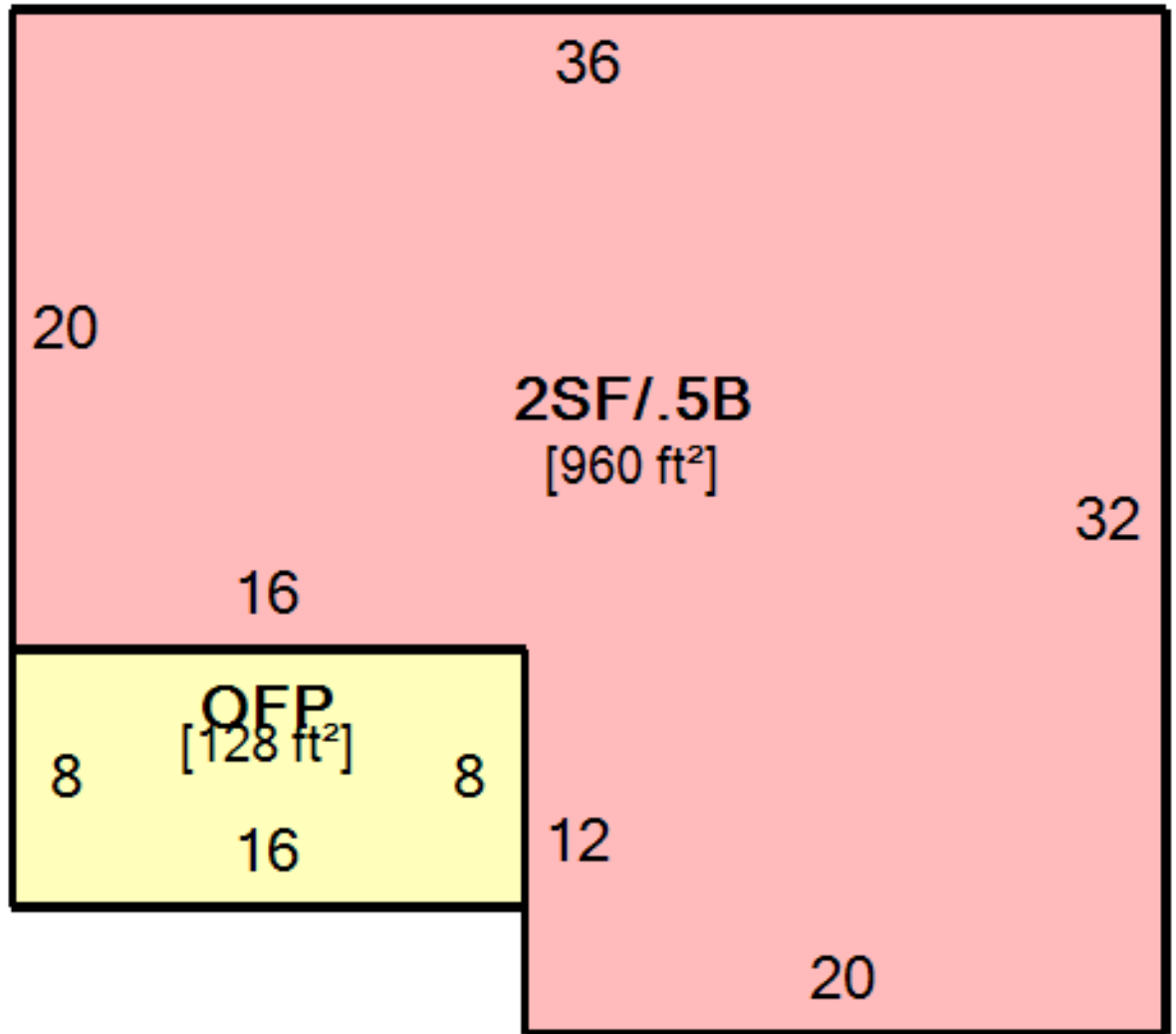

2